

**M/s.The Institute of Entrepreneurship Development**  
(Implementing Agency - Krishnagiri Coir Cluster)

**Tender No:** SFURTI-II/TN-KGRI/BLDG-001/2019-20 dated 13.01.2020

**Tender for Construction of Industrial Work Shed Buildings and Amenities for  
the Common Facility Center of Krishnagiri Coir Cluster**

**CORRIGENDUM-1 dated 01.02.2020**

The above tender was already published in the website on 13.01.2020 and the last date for submission of tender documents for the above tender is **05.02.2020, 03.00 P.M.** Based on the queries received through mail/letters, the following amendments are issued in the tender schedule:

<b>S.No</b>	<b>Page No</b>	<b>Clause No.</b>	<b>Existing Clause</b>	<b>Revised Clause</b>
1.	13	Annexure – I	(To Add)	Schematic drawing for electrical arrangements are included in tender document.

**DIRECTOR**

# ELECTRICAL DRAWING , FOR M/S-"KRISHNAGIRI COIR CLISTER PRIVATE LTD"

## KRISHNAGIRI TALUK & DISTRICT.

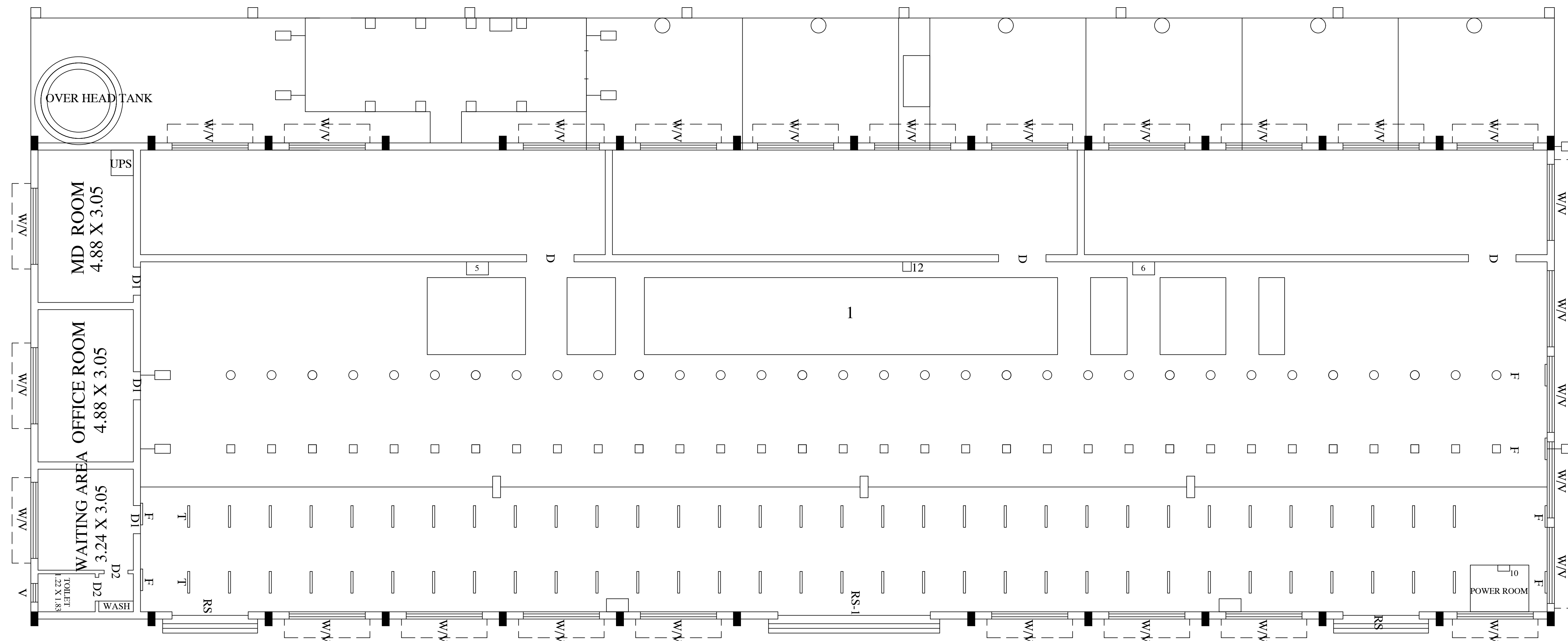

- 1.C.T PANEL
- 2.A.P.F.C PANEL
- 3.S.S.B 1
- 4.S.S.B 2
- 5.A. PANEL
- 6.B.PANEL
- 7.C.PANEL
- 8.TRANSFORMER
- 9.E.B.POST
- 10.WATER PUMP STARTER
- 11.L.MCB
- 12.M.C.MCB 1,2
- 13L.C.MCB 1,2
- 14.TUBE LIGHT
- 15.FOCUS LIGHT
- 16.STREET LIGHT-3NOS
- 17.UPS -1200W

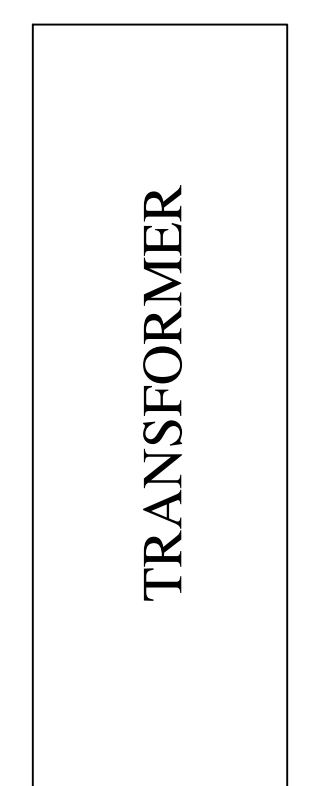
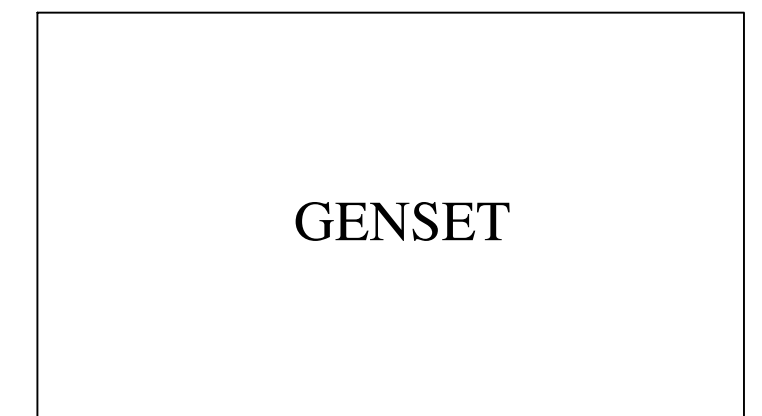
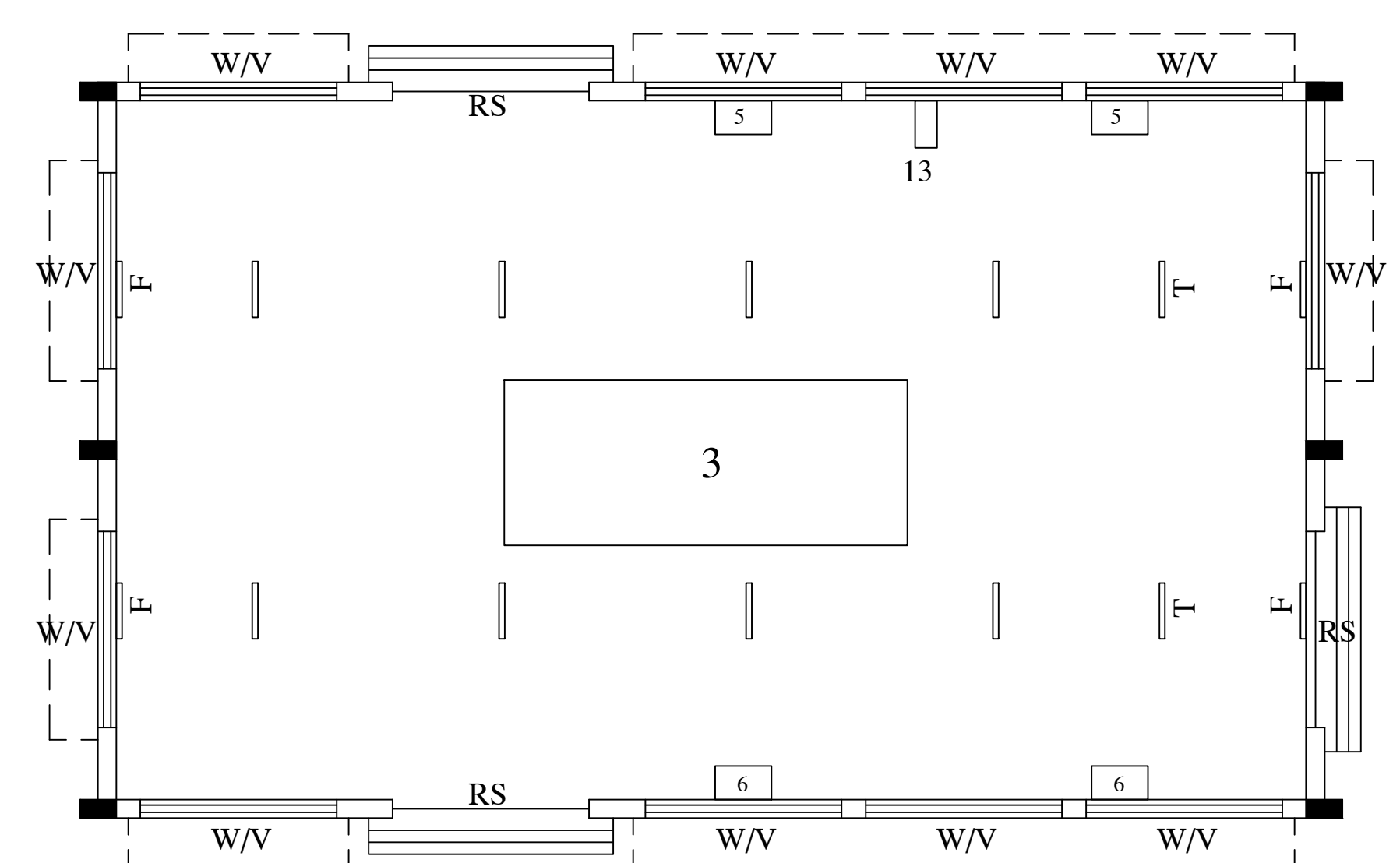
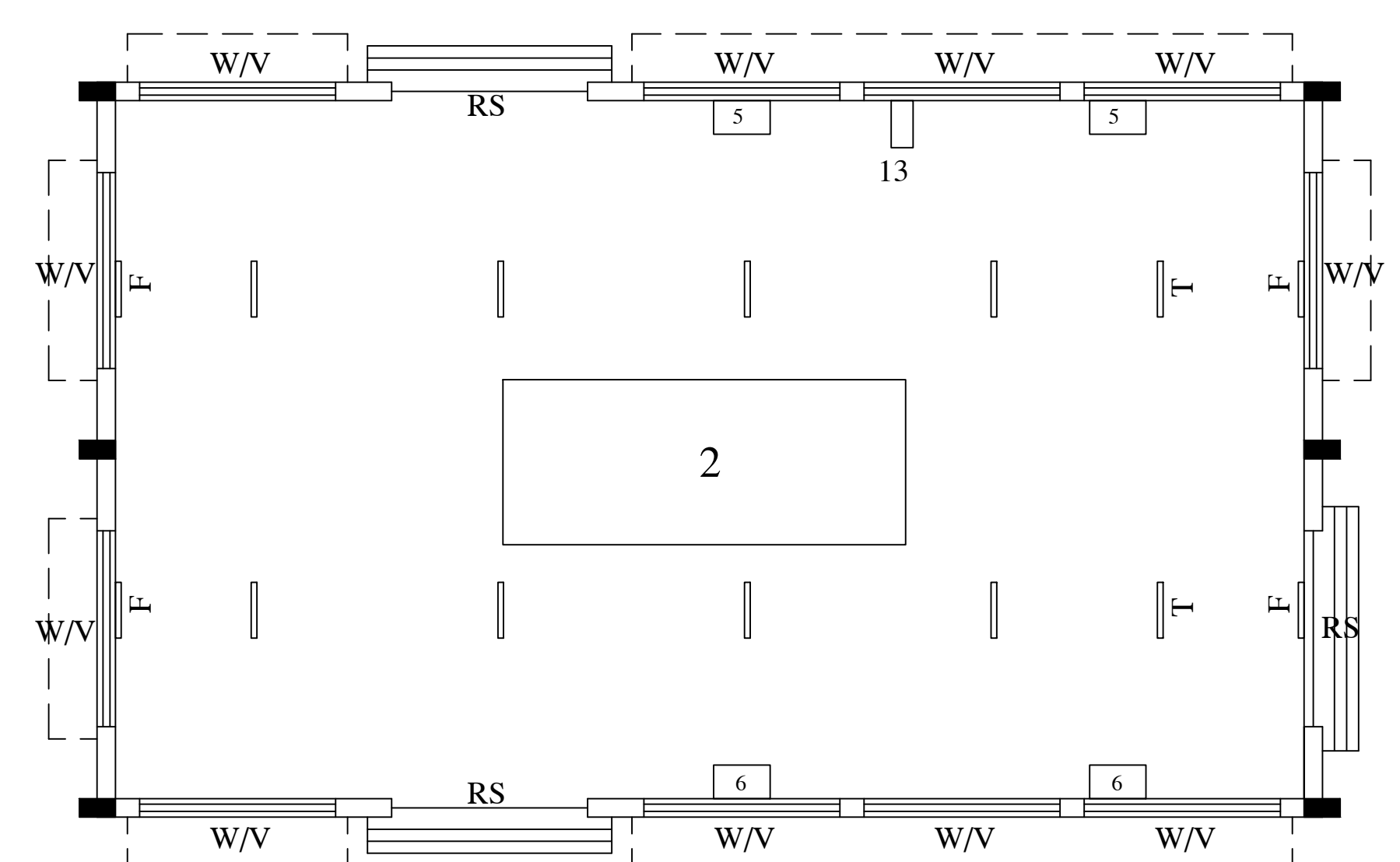

**M/s.The Institute of Entrepreneurship Development**  
(Implementing Agency - Krishnagiri Coir Cluster)

**Tender No: SFURTI-II/TN-KGRI/BLDG-001/2019-20 dated 13.01.2020**

**Tender for Construction of Industrial Work Shed Buildings and Amenities for  
the Common Facility Center of Krishnagiri Coir Cluster**

**RESPONSE TO PREBID QUERIES**

<b>Sl. No</b>	<b>Clause No.</b>	<b>Clarification Sought</b>	<b>Pre-Bid Query Response</b>
1.	Page No.12 Annexure – I	Electrical work specification required	Schematic drawing for electrical arrangements are included in tender document (Refer Corrigendum 1)
2.	Page No.12 Annexure – I	Capacity of Toilet blocks and tanks	Schematic diagram of the Toilet rooms are already given in Tender document. Capacity of toilet tanks - 2000 litres (Syntex Tank)
3.	Page No.13 Annexure – I (BoQ)	Septic tank and rain water harvesting is not in the bill of quantity	Septic tank and rain water harvesting are included in the scope of the Contractor. Capacity of Septic Tank – 7000 litres, Capacity of RWH – 4000 Litres
4.	Page No.13 Annexure – I (BoQ)	Whether bore well and water facility have been arranged	Borewell water facility will be arranged and the power cost to be borne by the contractor.
5.	Page No.6 Clause-12	Shall Tender document Submit through Postal	Yes. Mentioned in tender document (Refer Page No.6, Clause 12 (f) – Submission of Tender in Two cover system)
6.	-	Solar System included or not	Not included in the scope of Contractor
7.	Page No.12 Annexure – I	As per drawing, the building is to be constructed using Pre fabricated Pillar	Yes (Refer page No.12 Building Drawing – Annexure I)